



SPX100 High-Pressure Hose Pumps

Features and Benefits

- High-strength, twin-bearing hub integrated into the pumphead
- Rotor always fully and centrally supported by its own bearings
- Fail-safe shaft design
- New flat shim and improved epoxy shoe design
- Faster hose changing and improved sealing
- Easy access to shims and shoes
- Unique buffer zone provides protective barrier between pumphead and gearing
- Patented direct-coupled design
- Ultra compact planetary gearing
- No drive alignment for faster set-up
- No coupling or baseplate for compact footprint
- Adapter available for fitting hydraulic or pneumatic motors
- Improved frame design
- Increased corrosion resistance
- Compact design, low maintenance,
- Two year warranty

Performance Chart

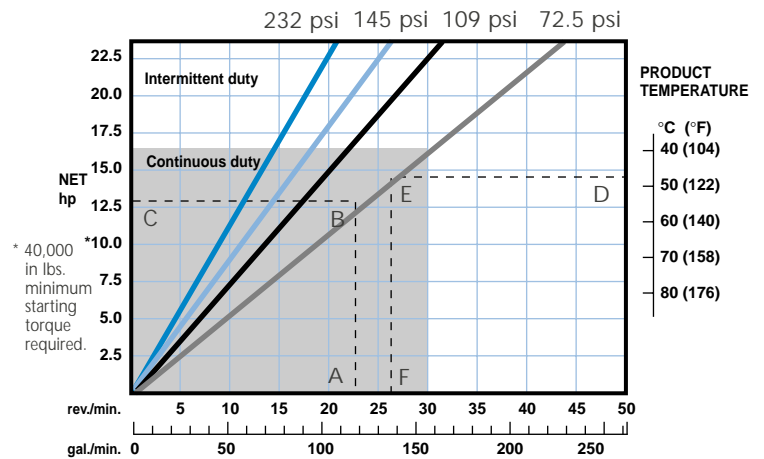

How to calculate speed/horsepower

- A Flow required, indicates pump speed
- B Calculated discharge pressure
- C Horsepower required
- D Fluid temperature
- E Calculated discharge pressure
- F Maximum recommended pump speed**

** For maximum hose life, speed point (A) should be lower than temperature adjusted speed point (F). See example points (A) thru (F).

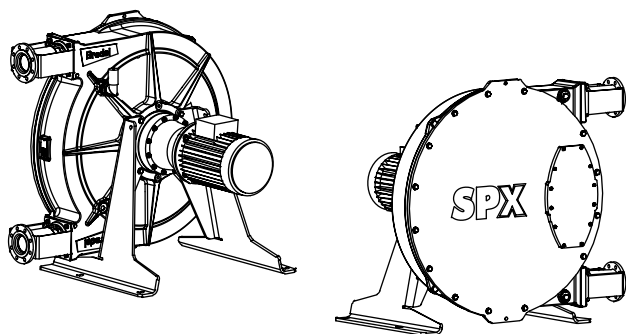
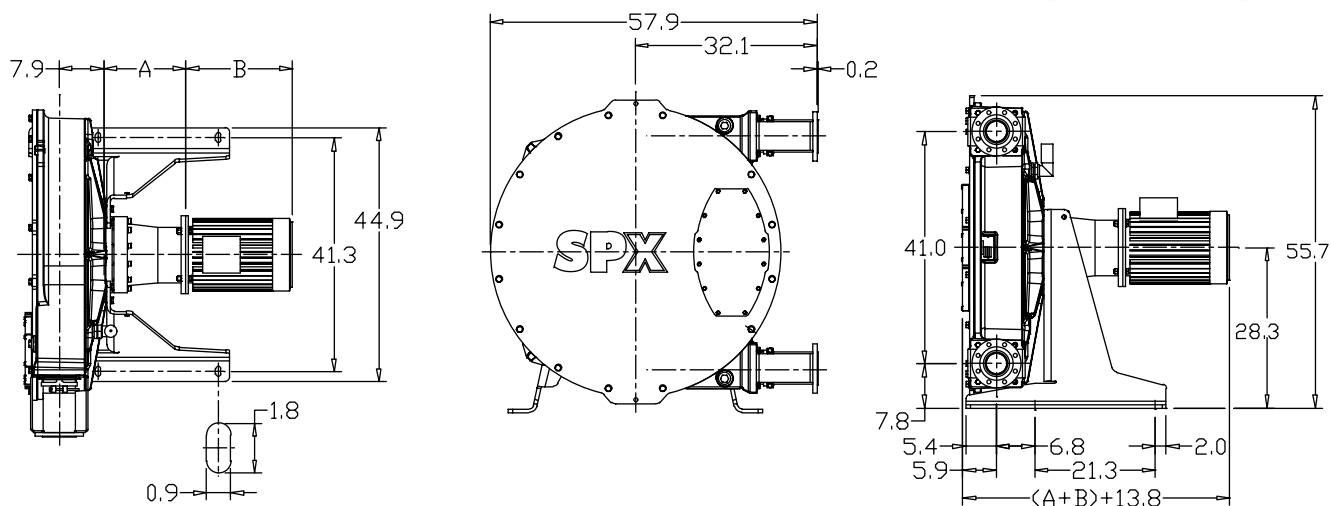

NOTES:

1. ALL DIMENSION ARE FOR REFERENCE ONLY.
2. WHEN INSTALLING, ALLOW 96-128' LINEAR CLEARANCE TO FLANGE FOR HOSE CHANGING

GEAR REDUCER	INPUT FRAME	A	WT. LBS.	MOTOR P/N	B	FRAME	HP	ENCLOSURE	WT. LBS.	
GRD2150	210TC	11.6	280	P21G3882	17.0	213TC	7.5	TEFC-EM	170	
	250TC	14.3	294	P21G1101	17.0	213TC	7.5	TEFC-XE	180	
	280TC	**	**	P21G3888	17.1	213TC	7.5	TEFC-EMT	170	
GRT13150	210TC	14.3	318	P21G1091	17.1	213TC	7.5	TEFC-XEX	185	
	250TC	17.0	332	P21G3863	16.9	215TC	7.5	FCEZ-EM+	185	
	280TC	**	**	P21G1034	17.8	213TC	7.5	FCXP	154	
GR04150	210TC	16.3	324	P21G3883	17.0	215TC	10	TEFC-EM	185	
	250TC	19.1	338	P21G1102	17.0	215TC	10	TEFC-XE	190	
	280TC	**	**	P21G3889	17.1	215TC	10	TEFC-EMT	185	
GRT13155	210TC	14.8	**	P21G1092	17.1	215TC	10	TEFC-XEX	185	
	250TC	17.5	**	P21G3864	16.9	215TC	10	FCEZ-EM+	190	
	280TC	**	**	P21G1139	17.8	215TC	10	FCXP-EM	154	
SPX100 Pumphead				2251	P25S3053s	21.8	254TC	15	TEFC-EM	242
				P25G1124	21.3	254TC	15	TEFC-XE	300	
				P25G1110	22.3	254TC	15	TEFC-XEX	300	
				P25G3375	21.3	256TC	15	FCEZ-EM+	300	
				P25G1029	21.3	254TC	15	FCXP-EM	290	
				P25S3055a	21.8	256TC	20	TEFC-EM	268	
				P25G1111	21.3	256TC	20	TEFC-XEX	345	
				P25G3376	21.3	256TC	20	FCEZ-EM+	300	
				P28S3052a	24.2	284TC	25	TEFC-EM	350	
				P28G1053	23.1	284TC	25	TEFC-XEX	425	

Notes: Dimensions shown are based on the standard pump and motor configuration. Overall length may vary depending on actual motor selection.

** - Contact Factory for dimensions and weights.

SPX100 High-Pressure Hose Pumps

Technical Specifications

Displacement: 5.28 gal/rev
 Supply: 230/460 or 575 three phase
 Operating Speeds: Up to 30 rpm continuous
 Up to 44 rpm intermittent
 Fluid Temperature Range: -4° to 175°F
 Hose Lubricant Required: 15.8 gallons
 Flow Range: Up to 232 gpm
 Discharge Pressure: Up to 232 psi
 Suction pressure: 28 ft. lift to 23 psi
 Available Hose Materials: Natural Rubber, BUNA N, BUNA K, EPDM, Hypalon (pending)
 Available Insert Materials: Polypropylene, 316 SS, PVDF, PVC
 Fittings: 4" 150# Flange

Materials of Construction

Pumphead: Cast iron
 Rotor: Cast iron
 Cover: Mild steel
 Hub: Cast iron
 Shoes: Epoxy
 Flanges and Flange Brackets: Galvanized steel or 304 SS
 Frame: Galvanized steel
 Hardware: Zinc plated steel or 304 SS
 Shaft: Alloy steel
 Shims: 316 SS
 Seals: NBR

The information contained in this document is believed to be correct, but Watson-Marlow/Bredel Pumps accepts no liability for any errors it contains, and reserves the right to alter specifications without notice.



Watson-Marlow, Inc.

37 UPTON TECHNOLOGY PARK, WILMINGTON, MA 01887-1018
 TEL: 800-282-8823, 978-658-6168 / FAX: 978-658-0041
<http://www.watson-marlow.com>